

MODEL	VOLUME			DOME VOLUME			WEIGHT		A (mm)	B (mm)	C (mm)	D (mm)	(E) (mm)
	liters	U.S. gal	cubic FT	liters	U.S. gal	cubic FT	Kg	LBS					
42x63	1274	336.5	45	150.6	39.79	5.32	201	443.1	2142±15	1107	490	874	(778)
42x72	1494	394.6	52.7	150.6	39.79	5.32	221	487.2	2396±15	1362	490	1115	(791)

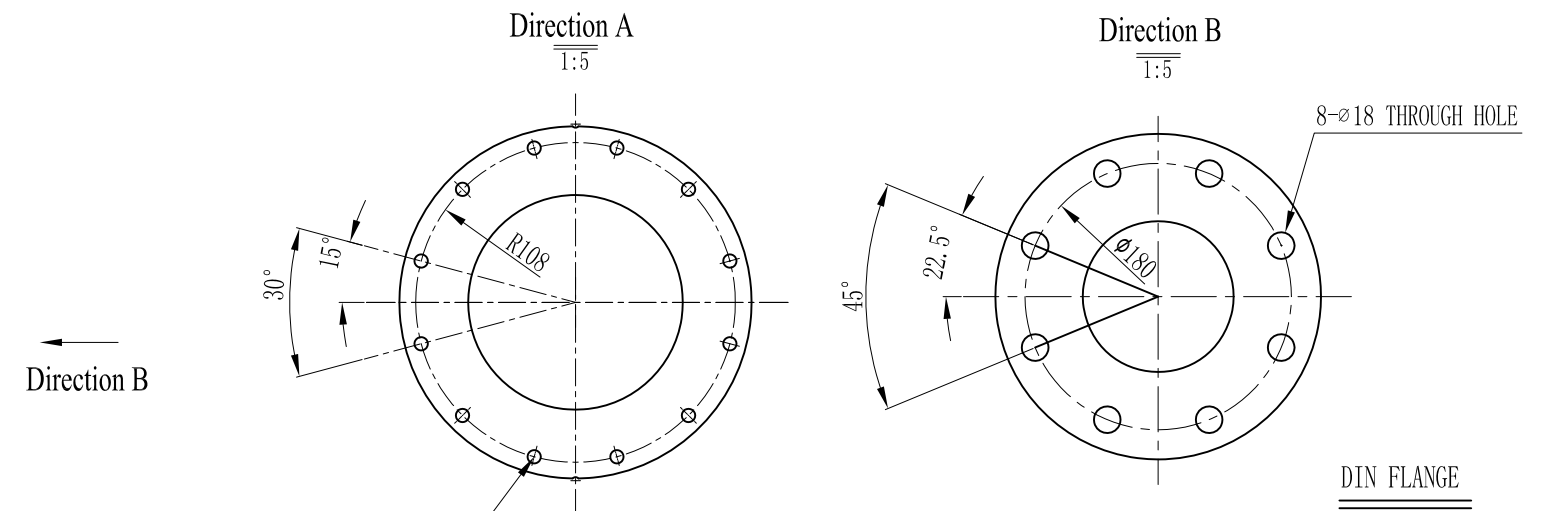
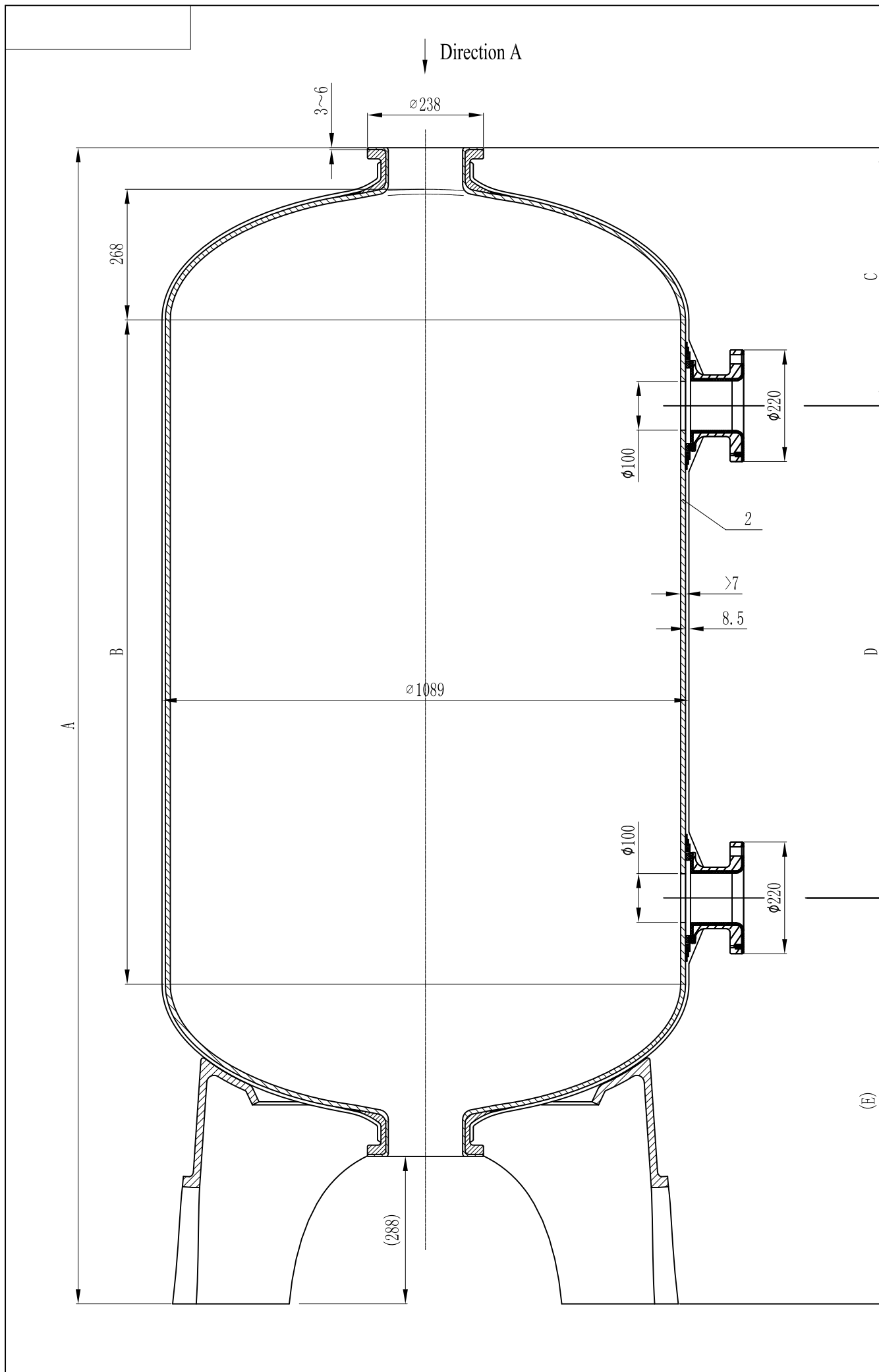

9 THROUGH HOLE
12-Ø

NOTES:

- TANK MUST MEET ALL APPLICABLE SPECIFICATIONS OF NSF/ANSI 044 STANDARD, LATEST REVISION.
- OPERATING SPECIFICATIONS:
 - MAXIMUM WORKING PRESSURE - 150 PSI (10.5BAR)
 - TEMPERATURE RANGE - 34-150° F (1-65°C)
 - MAXIMUM VACUUM - 5"Hg (127mm Hg)
- VISUAL LINER INSPECTION
 - NO MORE THAN 20 INTERNAL OR EXTERNAL BLEMISHES OR BURNT DEBRIS.
 - NO INTERNAL OR EXTERNAL BLEMISHES OR BURNT DEBRIS LARGER THAN 5×5mm.
 - NO INTERNAL BLEMISHES OR BURNT DEBRIS ALLOWED.
- ALL GLASS STRANDS FROM FIBERGLASS LINER TO BE BONDED AND COVERED.
- SURFACE TO BE FREE OF NICKS, SCRATCHES, RESIN AND GLASS.
- SURFACE FINISH.
- DIMENSIONS IN PARENTHESIS ARE REFERENCE ONLY.
- TANK TO BE BONDED TO BASE.
- USING A STANDARD LEVEL WITH TANK POSITIONED ON A LEVEL SURFACE, DATUM B TO BE PARALLEL WITH DATUM A. BUBBLE OF LEVEL MUST FALL COMPLETELY WITHIN LINES WHEN MEASURED AT 90° INTERVALS WHEN PLACED ON THE TOP OF THE FLANGE.
- AFTER THE TANK IS LEVELED, IT IS RECOMMENDED THAT THE TANK BE BOLTED TO THE FLOOR IN SIX POSITIONS PER THE TRIPOD BASE BOLT HOLE PATTERN WITH 3/8" ANCHORS.

VERSION NO.	DESCRIPTION OF CHANGES:	SIGNATURE	DATE
0	FIRST VERSION		
REFERENTIAL PLASTIC SHRINKAGE (IF NECESSARY):			
SIGNATURE		WAVE CYBER (SHANGHAI) CO., LTD.	
DESIGN	Jed Cao 2013.12.12		
INSPECTION	Tom Tang 2013.12.12		
APPROVAL	Tom Tang 2013.12.12		
THIS PRODUCT DRAWING CAN NOT BE COPIED AND/OR USED WITHOUT PRIOR WRITTEN APPROVAL OF WAVE CYBER.		SCALE 1 : 10	MODEL DESCRIPTION 42" FRP PRESSURE VESSEL (SIDE FLANGE OPENING)-(DIN)
		QUANTITY	SMOOTHNESS
		PROJECTION	COMPUTER CODE
		DRAWING NO. 1104223-00	VERSION NO. 0
		DO NOT MEASURE THE DIMENSIONS.	UNIT: MM
		TOTAL PAGE: 1	